

Ferry Grove Station Precinct

Winter 2010



Vision for Ferry Grove Station Precinct

In parallel with the Keperra to Ferry Grove Rail Upgrade project, there is an opportunity to develop a broader vision for the Ferry Grove Station Precinct. This vision could see the integration of a mixed-use development on site with the upgraded Ferry Grove station.

Two potential visions for the station precinct have been developed for community comment. Each vision addresses Brisbane City Council's Upper Kedron/ Ferry Grove Local Plan.

The first vision could result in a mixed-use precinct with a blend of facilities, including opportunities for retail, office space and a new tavern.

The second vision focuses on residential development, providing opportunities for a greater proportion of medium-density dwellings with some supporting retail/ commercial space.

We invite you to comment on the visions for the Ferry Grove Station Precinct.

An information session has been planned to give the community a chance to discuss the visions with the project team.

Date: Saturday 17 July 2010

Time: 9am – 1pm

Location: Ferry Grove Bowls Club, 20 Tramway Street (corner of Samford Road), Ferry Grove

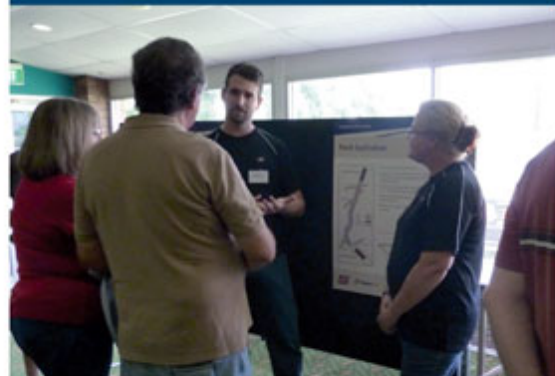

Tomorrow's Queensland:
strong, green, smart, healthy and fair

Toward 
Tomorrow's Queensland

 **Queensland**
Government

Ferry Grove Station Precinct

Both visions will:

- capitalise on the railway track duplication and station upgrades
- integrate with the upgraded station facilities
- deliver Transport Associated Development outcomes
- create a pedestrian focussed environment
- promote activity in and around the station core
- provide commuters with access to a broader range of convenience uses
- address Brisbane City Council's Upper Kedron / Ferry Grove Local Plan.

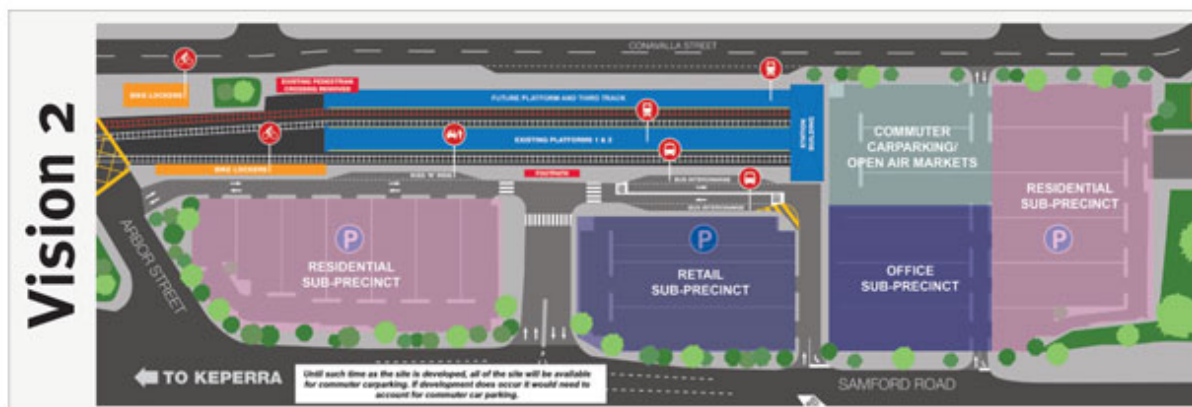
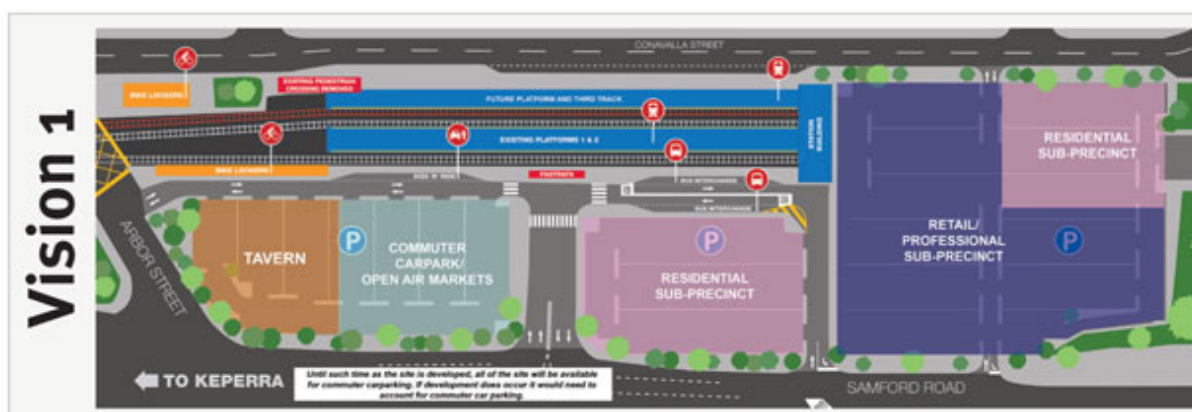

Your feedback

We are seeking your feedback on the visions for the Ferry Grove Station Precinct.

To register your feedback, go to:
www.transport.qld.gov.au/ferrygrovestationprecinct
or cut off and send in the attached feedback form.

To contact the project team call 1800 453 768*

*Freecall Australia-wide. Charges apply from mobile phones or pay phones.

**You can provide formal feedback on the visions
from Monday 12 July 2010 until close of business
Monday 9 August 2010.**



Transport Associated Development can include:

- commercial
- high or medium density residential, retail or recreational facilities
- open or recreational spaces
- community
- educational
- government
- places of worship.

This means, in the future, there may be shops, residential dwellings or community facilities.



Vision 1

This vision could create a mixed-use precinct at Ferny Grove station that may include:

- a tavern
- supporting residential sub-precincts (3 storey unit buildings)
- retail / professional uses (such as a supermarket, minor retail and professional/office).

If this is the vision for the Ferny Grove Station Precinct, the Department of Transport and Main Roads will explore timely opportunities for re-establishment of a tavern within the station precinct. The balance of the site will be delivered in a manner subject to market demand.

The Government remains committed to retaining commuter car parking at Ferny Grove station. Therefore, any Transport Associated Development on the site must account for commuter car parking.

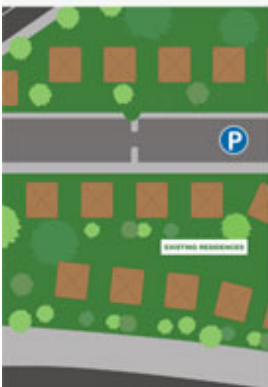

Vision 2

This vision could create a predominantly residential precinct supported by:

- quality office space within a dedicated precinct
- retail (such as a supermarket and minor specialty stores).

If this is the vision for the Ferny Grove Station Precinct, development of the site will be delivered in a manner subject to market demand.

The Government remains committed to retaining commuter car parking at Ferny Grove station. Therefore, any Transport Associated Development on the site must account for commuter car parking.

We welcome your feedback about the project

Your comments: _____

Name: _____ Organisation: _____

Postal address: _____ Postcode: _____

Phone (business hours): _____ Fax: _____

Email: _____ Please tick if you wish to receive updates by post: Post Email

Thank you for your feedback on the Ferny Grove Station Precinct.

Privacy Statement: In accordance with the Queensland Government's privacy guidelines, any information you supply as part of the consultation process will be used solely for the purpose of gauging community feedback regarding the Ferny Grove Station Precinct. It will be accessible only to the project team members and consultants undertaking work on their behalf. This information will not be disclosed to any third party without your consent or unless required by law.

What happens next?

Ferry Grove Station Precinct

The next steps would depend on the final vision for the Ferry Grove Station Precinct. You will be kept informed after the comment period closes.

Time line



Related project update

Keperra to Ferry Grove Rail Upgrade

The Keperra to Ferry Grove Rail Upgrade project will tackle traffic congestion and encourage people to use this more sustainable form of travel. The upgrade will increase rail capacity on the Ferry Grove line by duplicating 3.2km of track.

The project will also upgrade the Ferry Grove station to increase the number of car parking spaces, add bicycle storage, improve the traffic flow into and out of the station and improve the bus interchange. Importantly, the upgrade will improve safety and security around the station and make the station fully accessible.

Detailed design for the transport project is expected to be completed by November 2010. Information sessions will be held to show the designs to the community.

Track duplication works within the existing rail corridor is expected to start in late 2010. The upgrade of the Ferry Grove station and car park is expected to start in early 2011.

For more information about the Rail Upgrade Project, visit: www.qr.com.au/seqip